



City of Perth
City Planning Scheme
No. 2

Schedule 8

Special Control Area 3.0

West Street



Version #	Decision Reference	Synopsis
1	1 April 2005	Gazetted
2	24 February 2017	Amended



3.0 WEST STREET SPECIAL CONTROL AREA

3.1 Special Control Area

The following provisions apply to the land area marked as Figure 3 – West Street Special Control Area.

3.2 Objective

The objective is to facilitate the development of the land comprising the West Street Special Control Area as a whole and in a coordinated manner.

3.3 Plot Ratio

For the purpose of determining plot ratio the West Street Special Control Area shall be treated as one site.

3.4 Car Parking

For the purpose of determining the tenant parking provision the West Street Special Control Area shall be treated as one site.

3.5 Dwelling Density

For the purpose of determining dwelling density, the land area of the West Street Special Control Area Map shall be treated as one site.

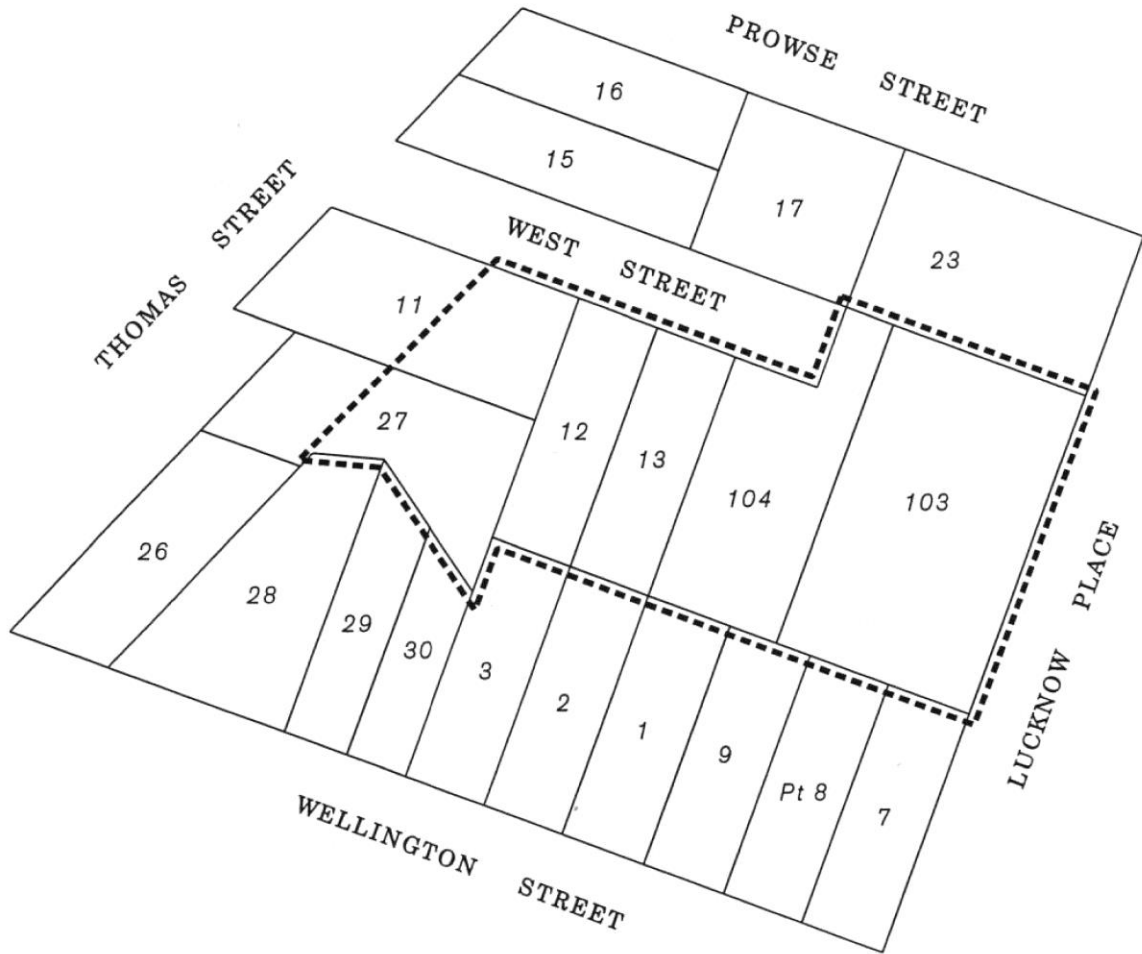

----- Site Boundary

1-5 WEST STREET, 26-28 THOMAS STREET & 3-9 LUCKNOW PLACE, WEST PERTH



Figure 3 – West Street Special Control Area